

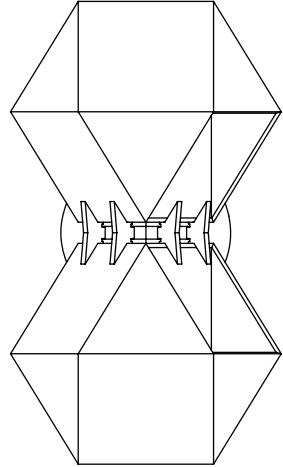

FILE#: E488971

FILE#: E503097

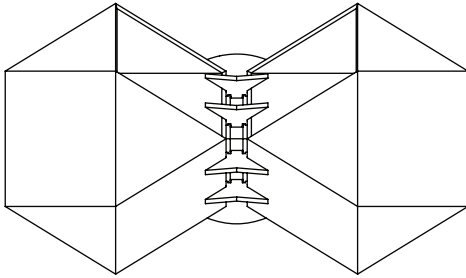

WELLES GLASS

Double sconce Installation Guide

- Certified electrician recommended for electrical installation.
- Terminal Block not included. Installation may require advice from a qualified person.
- For all LED fixtures, use only with class 2 power unit.
- Junction box rated for minimum of 35lbs or structural blocking required to support fixture.
- The light source contained in this luminaire shall only be replaced by the manufacturer or his service agent or a similar qualified person. Contact manufacturer for service.
- For controllable luminaires, the classification of insulation that has been maintained between LV supply and control conductors shall be provided.... basic insulation, reinforced insulation etc.

*** IMPORTANT: Please provide email confirmation that your order and its related components have been received in their entirety and in good condition. Failure to do so within 7 days of delivery will waive all product warranties.**

GABRIEL SCOTT
LUMINAIRE



Provided supplies

- Welles Glass volumes, connected in pairs
- Universal T-bar
- Installation screws

Required tools and hardware

- Screwdriver
- Drywall anchors suitable for 25lbs for mono points
- 4x 2-pole wiring terminals, screws or screwless, 12-18AWG (1.0-2.5mm²) rated for 600V, 15A / ex: WAGO 222-412
- LED driver; input: local line voltage, output: 12Vdc SELV, 5A, Max 60 watt, Class 2 LED driver

STEP 1

Shut down associated electrical breaker and wire LED driver to power source. Secure driver in junction box using provided universal T-bar

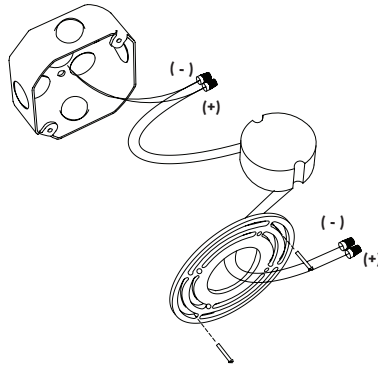

STEP 2

Connect exposed wire leads from LED driver to Welles Glass Double Sconce. On Gabriel Scott fixtures the black wire is positive (+) and the white is neutral (-). Once connected, firmly screw the Double Sconce and canopy to the already installed universal T-bar.

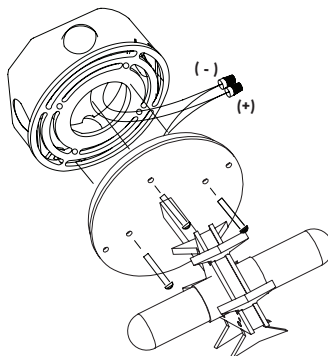

STEP
3

Once the fixture is mounted on the wall, remove the glass retaining rings from the fixture. To install the Welles Glass volumes to the fixture, slide the glass over the LED bulb and thread the glass retaining ring onto the fixture as demonstrated below.

Note:

The orientation of the large square access hole is up to the user. Either towards the wall, ceiling or floor.

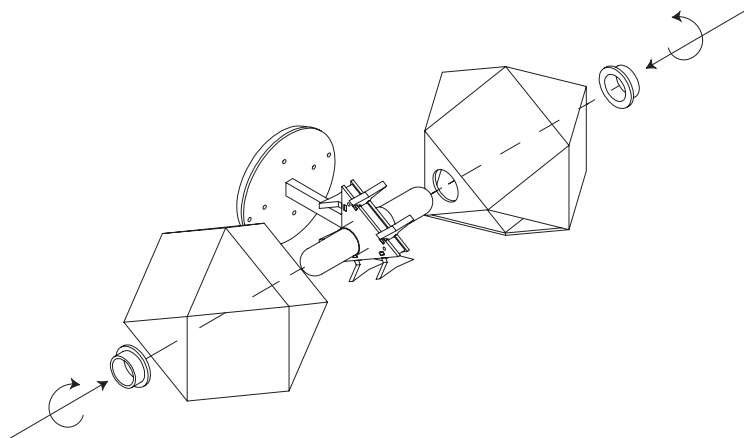

Exploded view of Welles Glass Double Sconce installation:

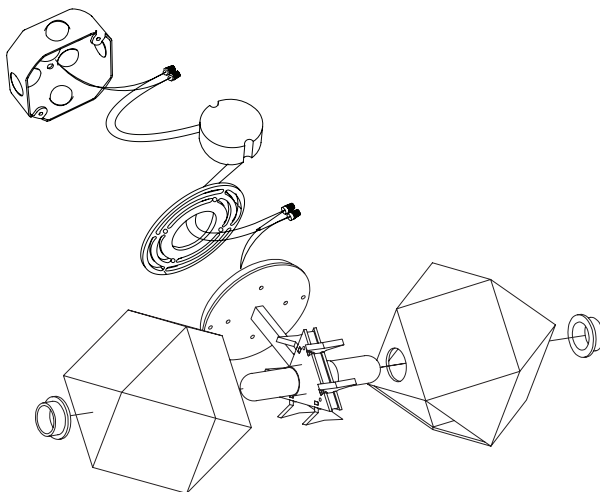

GABRIEL SCOTT
DESIGN