



HEMERA

DESK LAMP

Like the brutalist architecture of 60 years ago that it references, the Hemera Desk Lamp is powerful in its simplicity of form.

Designed for the New Volumes™ collection, the two solid circular volumes intersect with no overtly visible light source, creating a striking desktop monolith and a lighting device of refined functionality.

AVAILABLE FINISHES



ELBA
MARBLE

TECHNICAL

MATERIAL	HONED ELBA MARBLE AND ANODISED ALUMINIUM
LAMPING	8.5W, E27, 806LM, 2700K, WARM WHITE SUPPLIED WITH AUS/NZ SALES (220-240V) ONLY GLOBES ARE SUPPLIED WITH AUS/NZ ORDERS ONLY E27 LAMP HOLDER IS SUPPLIED FOR 240V REGION. E26 LAMP HOLDER IS SUPPLIED FOR 120V REGION.
LED LIFESPAN	15,000 HRS
CORD	BLACK WITH IN-LINE SWITCH AND AS/NZS PLUG USA/CAD NEMA-1, 2-PIN PLUG SUPPLIED FOR NORTH AMERICA / CANADA
IP RATING	IP20 - FOR INDOOR USE ONLY
CERTIFICATION	AS/NZS - 60598.2.1 EN - 60598.2.1 UL TESTING AVAILABLE UPON REQUEST

SKU CODES	EG. HL.M-ELB = HEMERA DESK LAMP IN ELBA HL.M-ELB HEMERA DESK LAMP ELBA MARBLE
PRODUCT DIMENSIONS	Ø390 H 362 / Ø15.4" H 14.3"
PRODUCT WEIGHT	11KG / 24.2LB
PACKAGING DIMENSIONS	L 750 W 500 H 280 / L 29.5" W 19.7" H 11"
PACKAGING WEIGHT	11KG / 24.5LB

DIMENSIONS

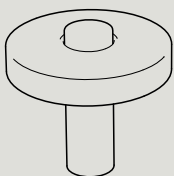

HL
Ø390 H362
Ø15.4" H14.3"