



HEMERA

DESK LAMP

Like the brutalist architecture of 60 years ago that it references, the Hemera Desk Lamp is powerful in its simplicity of form. Designed for the New Volumes™ collection, the two solid circular volumes intersect with no overtly visible light source, creating a striking desktop monolith and a lighting device of refined functionality.

AVAILABLE FINISHES



ELBA
MARBLE

TECHNICAL

MATERIAL	HONED ELBA MARBLE AND ANODISED ALUMINIUM
LAMPING	8.5W E27 LED, 806 LM, 2700K WARM WHITE SUPPLIED WITH AUS/NZ SALES (220-240V) ONLY (120V) E26 LAMP HOLDER SUPPLIED FOR NORTH AMERICA/CANADA.
LED LIFESPAN	15,000 HRS
CORD	BLACK WITH IN-LINE SWITCH AND AS/NZS PLUG USA/CAD NEMA-1, 2-PIN PLUG SUPPLIED FOR NORTH AMERICA /CANADA
IP RATING	IP20 - FOR INDOOR USE ONLY
CERTIFICATION	AS/NZS - 60598.1, 60598.2.4 EN - 60598.1, 60598.2.4 UL TESTING AVAILABLE UPON REQUEST

PRODUCT CODES SKU

EG. HL.M-ELB = HEMERA DESK LAMP IN ELBA

HL.M-ELB	HEMERA DESK LAMP ELBA MARBLE (M-ELB)
DIMENSIONS	Ø390X362MM / Ø15.4X14.3"
WEIGHT	11KG / 24.2LB
PACKAGING	75X50X28CM / 29.5X19.7X11"
PACKAGING WEIGHT	11KG / 24.5LB

DIMENSIONS

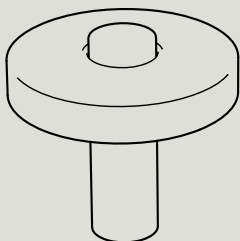

HL
Ø390 H362
Ø15.4" H14.3"

twentieth
www.twentieth.net
sales@twentieth.net
323.904.1200